

Follow one's inclinations photo !



Mobile phone RC





Normal RC

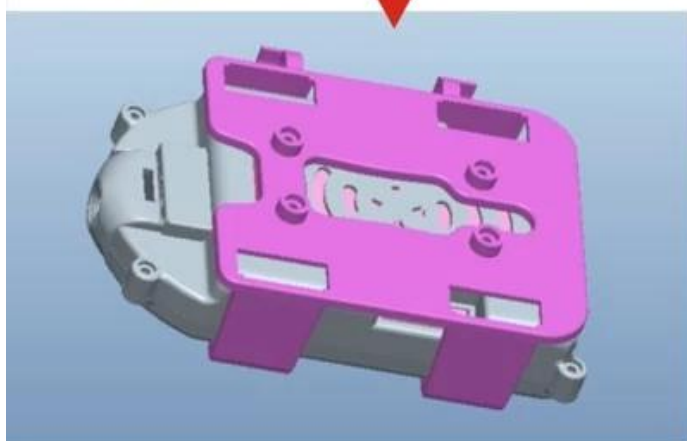
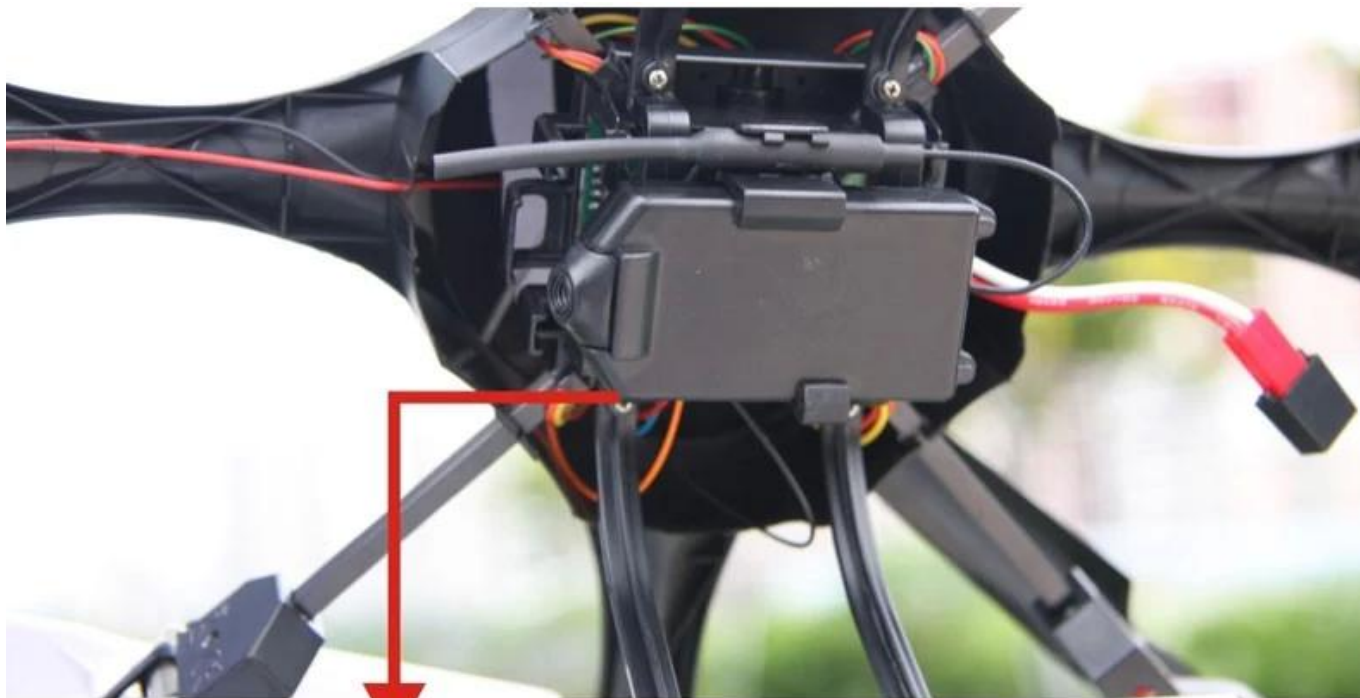

WIFI & FPV module system

Normal RC

Mobile phone RC



360° version



Press, 360 aircraft will do reverse action

Press, 360 aircraft will do reverse action

FUNHover product features

PilotFUN available on Apple and Google App

Support iOS and WiFi

VGA (640x480) / QVGA (320x240) / QQVGA (160x120) resolution

iOS and Android compatible

Digital/Analog flying control interface selection

Used to right-hand / used to left-hand control mode selection

Support smart phone/tablet's G-sensor control mode

Adjustable sensitivity

Support smart phone/tablet's G-sensor control mode and adjustable sensitivity

Apple store or Google Play App name: PilotFUN (free)

WiFi connection for your iOS device.

Real-time video transmission with VGA (640x480) / QVGA(320x240) / QQVGA(160x120) flexible setting for iOS and Android device.

Photo taking and stored into smart phone/tablet system library.

Video recording and stored into smart phone/tablet system library.

Digital /Analog flying control interface selection.

Used to right-hand /used to left-hand control mode selection.

Support smart phone/tablet's G-sensor control mode and adjustable sensitivity.

How to start:

Download *PilotFUN* from Apple store /Google Play and install it in your smart phone/tablet device. Install FUNHover onto the helicopter and connect the 4-wire cable between FUNHover and helicopter control board.

Connect the battery with the helicopter, wait for the FUNHover's green LED to be blinking. Use smart phone/tablet search the WiFi SSID: ToyRevo58343Bxxxxx , and make the WiFi connection first, then run the PilotFUN app.

Adjust the "Video quality" in setting menu appropriately, in general, all the iPad series and 4-core CPU Android device can do the VGA quality nicely, and if the video can not played fluently in your smart phone/tablet, please reduce the video quality to QVGA or QQVGA. Change the video quality setting will require to reboot the FUNHover & re-launch the app for new setting to be effective.

Let the FUN take off!

How to start:

PilotFUN Apple / Google / FUNHover FUNHover 4- LAN SSID ToyRevo58343Bxxxxx WiFi PilotFUN iPad 4-core CPU Android VGA QVGA QQVGA FUNHover & 038 FUN



Use smart phone/tablet search the WiFi SSID: ToyRevo58343Bxxxxx , and make the WiFi connection first,





then run the PilotFUN app

Starting...



The manipulation of the interface



Interface for parsing

The interface includes the following elements:

- 1 Setting**: Gear icon
- 2 Take Picture**: Camera icon
- 3 Record Video**: Video camera icon
- 4 LED Switch**: LED light icon
- 5 Fine Turning**: Wrench and screwdriver icon
- 6 G-sensor control**: Gyroscope icon
- 7 360° Tumble**: Atom icon
- Power Indicator**: Battery level icon
- Rotate / Transverse switch**: A vertical slider on the left side.
- Forward**: Upward arrow button with a four-leaf clover icon.
- Backward**: Downward arrow button with a four-leaf clover icon.
- Left_transverse**: Leftward arrow button with a four-leaf clover icon.
- Right_transverse**: Rightward arrow button with a four-leaf clover icon.
- Throttle**: A red circular throttle control at the bottom left, currently at **0%**.

1. Allow FUNHover
2. 3 5 7 9 TX / RX
3. 5 10 mins
- 4.
- 5.

6□□□□□

1. Press the “Setting” into the interface of system setup.
2. Press the “Take Picture” button to take the picture from the streamed video.
3. Press the “Record Video” button to record the video from the streamed video.
4. Press the “LED switch” button to turn ON/OFF the LED
5. Press the “Fine Turning” button to enter the fine turning mode to fine turn the balance of the helicopter
! Important: the value = 0 means the factory default setting
6. Press the “G-sensor control” button to enter the G-sensor control mode, the button controlled user interface will be disappeared.
7. Press the “360° Tumble” button to enter the tumble mode, and then press one of the 4 direction button to tumble the helicopter in that direction.



Setting

System Setting

Device Name ①

Wi-Fi Channel ② >>

Video Record Time ③ >>

Speed Mode ④ Standard ⑤ High

Copyright Glovast Technology Ltd. All rights reserved.
Version.1.0

1. Allow player to rename their FUNHover, only English alphabet, number, and “_”, “-” is valid for naming.
2. Allow player to change the WiFi channel for the chance of better signal TX/RX, channel options: 3, 5, 7, 9
3. Video record time: 5mins, 10mins, no limited (figure)
4. speed mode
5. High
2. 6. Close



Rotate / Transverse

R T

Rotate / Transverse switch
Press the R|T switch will swap the Left and Right button between Rotate and Transverse mode

Left_rotate

Right_rotate

Slide the throttle button up / down to increase / decrease the motor power
0%

Enjoy the happiness of flying and photography!









1x 3.7V 500mAh Li-ion battery
 4 * 1.5V AAA batteries
 30 screws
 120 screws
 6-9 screws
 14 screws

1x 2.4GHz antenna
 1x antenna
 1x antenna
 4x antenna
 1x antenna
 1x antenna
 1x antenna

TOPWIN INDUSTRY CO., LTD

ADD: 3 / F B C B
 86-755-83660365 83660404 E: sales@chinatopwin.com
 86-755-83660251 www.chinatopwin.com