



BUSINESS INTEGRITY



QUALITY ASSURANCE



PHYSICAL SHOOTING



QUALITY SERVICE

□□□□

2.4G□□□□30□□□□□□□4□□□□6□□□□□□□LED

□□□□/□□□□□/□□□□□□/□□□□□□□□1 button 360°□□ □□□□□□□□□□□□□□□□

4CH IOS&Android phone control quadcopter with 6 axis gyro

FUNHover

The App Controlled Helicopter Wi-Fi Receiver
- Realtime Video & Easy Flying



6 AXIS WIFI CONTROLLED
FPV DRONE WITH GYRO
CTW-028



Setting



Take
Picture



Record
Video



LED
Switch



Fine
Turning control



G-sensor



360°
Tumble



Follow one's inclinations photo !



Mobile phone RC



Normal RC

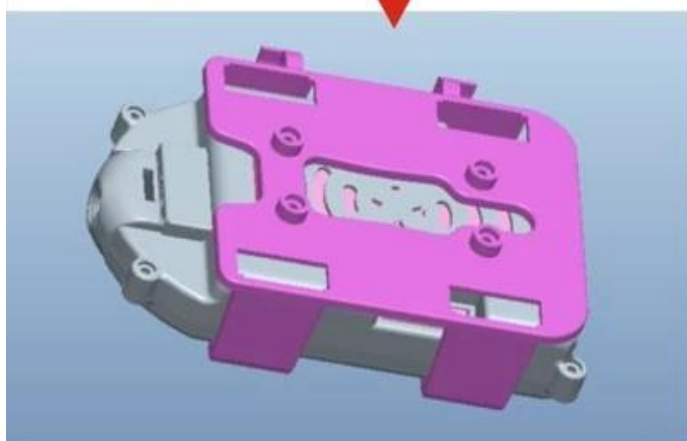
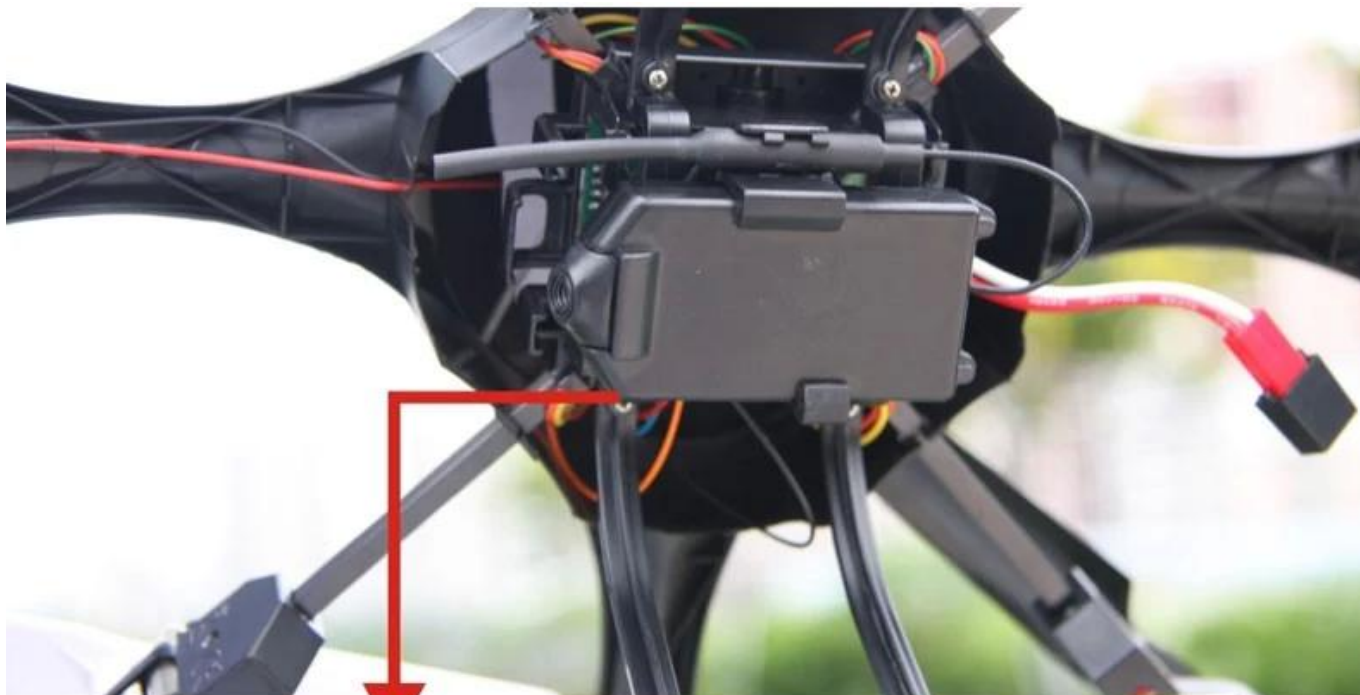

WIFI & FPV module system

Normal RC

Mobile phone RC



360° version

Download *PilotFUN* from Apple store /Google Play and install it in your smart phone/tablet device. Install FUNHover onto the helicopter and connect the 4-wire cable between FUNHover and helicopter control board.

Connect the battery with the helicopter, wait for the FUNHover's green LED to be blinking. Use smart phone/tablet search the WiFi SSID: ToyRevo58343Bxxxxxx , and make the WiFi connection first, then run the PilotFUN app.

Adjust the "Video quality" in setting menu appropriately, in general, all the iPad series and 4-core CPU Android device can do the VGA quality nicely, and if the video can not played fluently in your smart phone/tablet, please reduce the video quality to QVGA or QQVGA. Change the video quality setting will require to reboot the FUNHover & re-launch the app for new setting to be effective.

Let the FUN take off!

How to start:

1. Download PilotFUN from Apple store /Google Play and install it in your smart phone/tablet device.
2. Install FUNHover onto the helicopter and connect the 4-wire cable between FUNHover and helicopter control board.
3. Connect the battery with the helicopter, wait for the FUNHover's green LED to be blinking.
4. Use smart phone/tablet search the WiFi SSID: ToyRevo58343Bxxxxxx , and make the WiFi connection first, then run the PilotFUN app.
5. Adjust the "Video quality" in setting menu appropriately, in general, all the iPad series and 4-core CPU Android device can do the VGA quality nicely, and if the video can not played fluently in your smart phone/tablet, please reduce the video quality to QVGA or QQVGA.
6. Change the video quality setting will require to reboot the FUNHover & re-launch the app for new setting to be effective.
7. Let the FUN take off!



Use smart phone/tablet search the WiFi SSID: ToyRevo58343Bxxxxxx , and make the WiFi connection first,





then run the PilotFUN app

Starting. . .



The manipulation of the interface



Interface for parsing

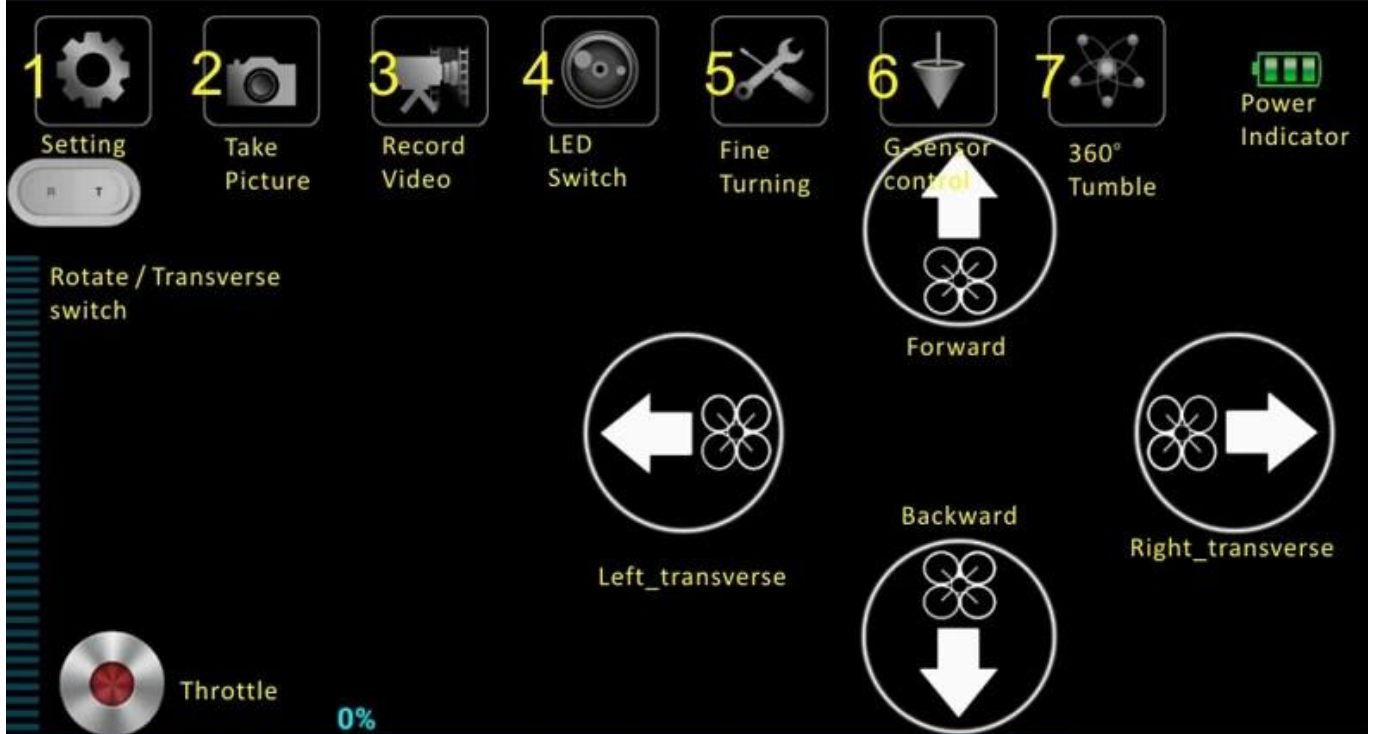

1. Allow ☐ FUNHover ☐ - ☐
2. ☐ WiFi ☐ 3 5 7 9
3. ☐ 5 ☐ 10 ☐
4. ☐
5. ☐

1. Press the “Setting” into the interface of system setup.
2. Press the “Take Picture” button to take the picture from the streamed video.
3. Press the “Record Video” button to record the video from the streamed video.
4. Press the “LED switch” button to turn ON/OFF the LED
5. Press the “Fine Turning” button to enter the fine turning mode to fine turn the balance of the helicopter
! Important: the value = 0 means the factory default setting
6. Press the “G-sensor control” button to enter the G-sensor control mode, the button controlled user interface will be disappeared.
7. Press the “360° Tumble” button to enter the tumble mode, and then press one of the 4 direction button to tumble the helicopter in that direction.



Setting

System Setting

Device Name

ToyRevo58343B011BB9

1

Wi-Fi Channel

Channel 3

2

>>

Video Record Time

5 minutes

3

>>

Speed Mode

4

☒ Standard

5

☐ High

Update

6 Close

Copyright Glovast Technology Ltd. All rights reserved.

Version.1.0

1. Allow player to rename their FUNHover, only English alphabet, number, and “_”, “-” is valid for naming.
2. Allow player to change the WiFi channel for the chance of better signal TX/RX, channel options: 3, 5, 7, 9
3. Video record time: 5mins, 10mins, no limited (figure)
4. speed mode
5. High
2. 6. Close



Rotate / Transverse

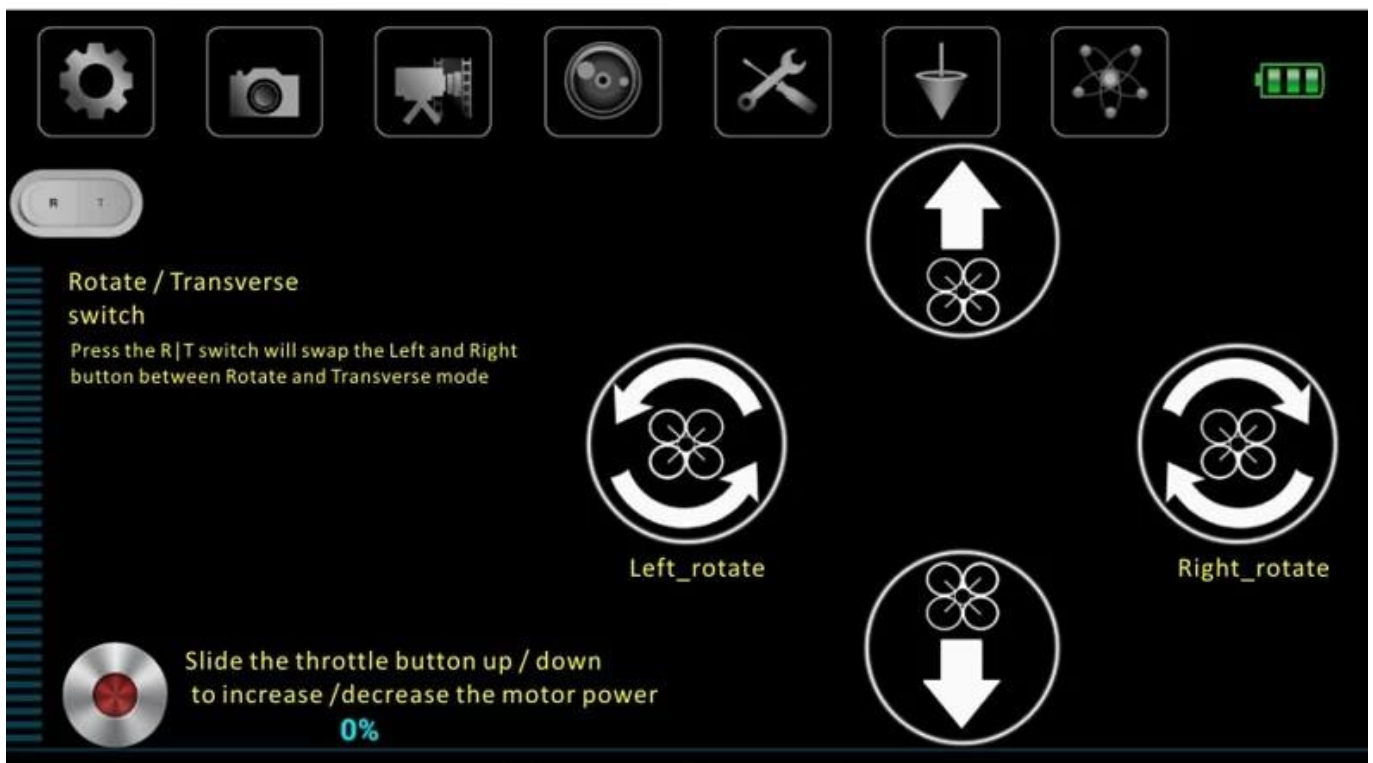

**Enjoy the happiness
of flying and photography !**









1 * 3.7V 500mAh 锂离子电池
 1 * 4 * 1.5V AA 碱性电池
 1 * 30cm
 1 * 120cm
 1 * 6-9cm
 1 * 14cm

1 *
 1 * 2.4G
 1 *
 1 *
 4 *
 1 *
 1 *
 1 *

1 * **TOPWIN**

1 * B-C 3 / F B

86-755-83660365 83660404 sales@chinatopwin.com

86-755-83660251 www.chinatopwin.com