



BUSINESS INTEGRITY



QUALITY ASSURANCE



PHYSICAL SHOOTING



QUALITY SERVICE

Product Functions

2.4G wifi with 300,000 pixel camera,4CH quadcopter with 6 axis gyro&LED light,up/down, forward/backward, turn left/turn right, left side flying/right side flying,hovering, one buttom 360°rolling steady flying□easy to control,suitable for indoor and outdoor flying.

4CH IOS&Android phone control quadcopter with 6 axis gyro

FUNHover

The App Controlled Helicopter Wi-Fi Receiver
- Realtime Video & Easy Flying



6 AXIS WIFI CONTROLLED
FPV DRONE WITH GYRO
CTW-028



Setting



Take
Picture



Record
Video



LED
Switch



Fine
Turning



G-sensor
control



360°
Tumble



Follow one's inclinations photo !



Mobile phone RC





Normal RC

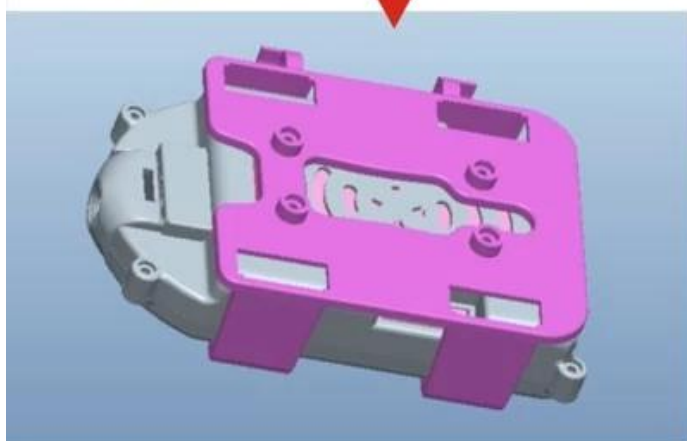
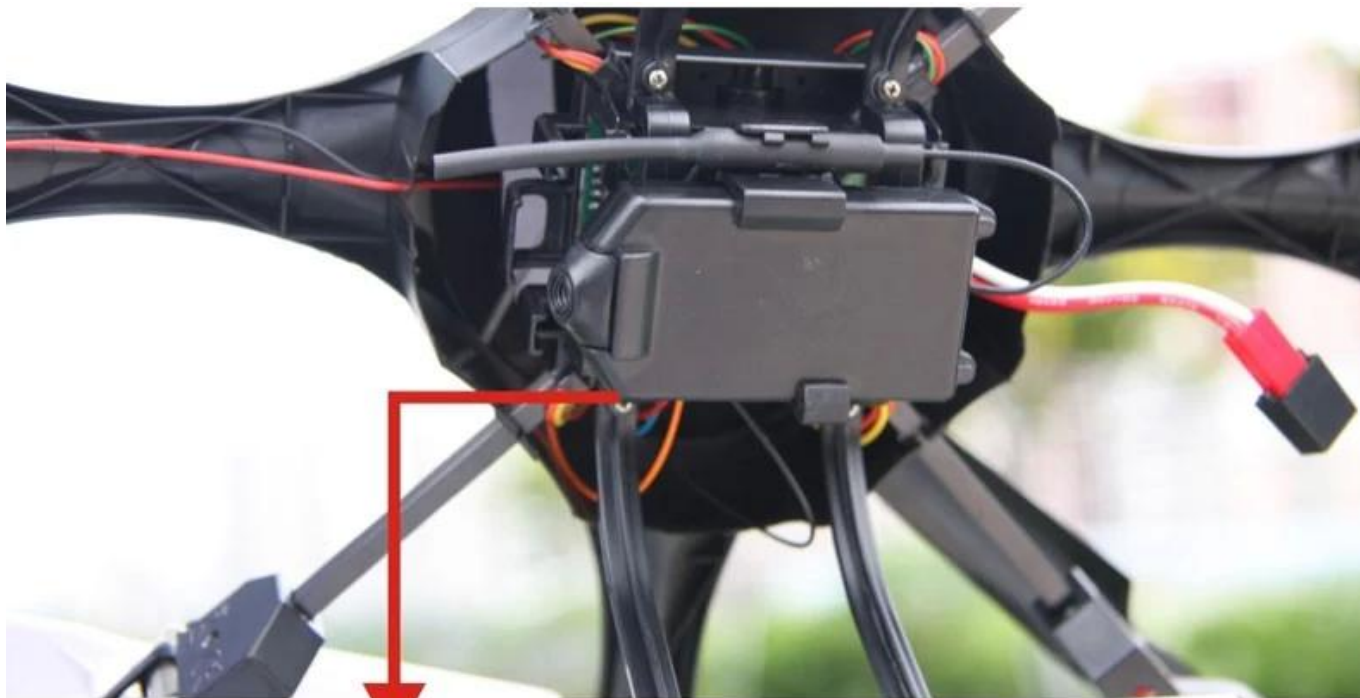

WIFI & FPV module system

Normal RC

Mobile phone RC



360° version



FUNHover product features

Apple store or Google Play App name: PilotFUN (free)

WiFi connection for your iOS device.

Real-time video transmission with VGA (640x480) / QVGA(320x240) / QQVGA(160x120).
flexible setting for iOS and Android device.

Photo taking and stored into smart phone/tablet system library.

Video recording and stored into smart phone/tablet system library.

Digital /Analog flying control interface selection.

Used to right-hand /used to left-hand control mode selection.

Support smart phone/tablet's G-sensor control mode and adjustable sensitivity.

Apple store or Google Play App name: PilotFUN (free)

WiFi connection for your iOS device.

Real-time video transmission with VGA (640x480) / QVGA(320x240) / QQVGA(160x120)
flexible setting for iOS and Android device.

Photo taking and stored into smart phone/tablet system library.

Video recording and stored into smart phone/tablet system library.

Digital /Analog flying control interface selection.

Used to right-hand /used to left-hand control mode selection.

Support smart phone/tablet's G-sensor control mode and adjustable sensitivity.

How to start:

Download *PilotFUN* from Apple store /Google Play and install it in your smart phone/tablet device. Install FUNHover onto the helicopter and connect the 4-wire cable between FUNHover and helicopter control board.

Connect the battery with the helicopter, wait for the FUNHover's green LED to be blinking. Use smart phone/tablet search the WiFi SSID: ToyRevo58343Bxxxxxx , and make the WiFi connection first, then run the PilotFUN app.

Adjust the "Video quality" in setting menu appropriately, in general, all the iPad series and 4-core CPU Android device can do the VGA quality nicely, and if the video can not played fluently in your smart phone/tablet, please reduce the video quality to QVGA or QQVGA. Change the video quality setting will require to reboot the FUNHover & re-launch the app for new setting to be effective.

Let the FUN take off!

How to start:

Download PilotFUN from Apple store /Google Play and install it in your smart phone/tablet device.

Install FUNHover onto the helicopter and connect the 4-wire cable between FUNHover and helicopter control board.

Connect the battery with the helicopter, wait for the FUNHover's green LED to be blinking.

Use smart phone/tablet search the WiFi SSID: ToyRevo58343Bxxxxxx , and make the WiFi connection first, then run the PilotFUN app.

Adjust the "Video quality" in setting menu appropriately, in general, all the iPad series and 4-core CPU Android device can do the VGA quality nicely, and if the video can not played fluently in your smart phone/tablet, please reduce the video quality to QVGA or QQVGA.

Change the video quality setting will require to reboot the FUNHover & re-launch the app for new setting to be effective.

Let the FUN take off!



Use smart phone/tablet search the WiFi SSID: ToyRevo58343Bxxxxxx , and make the WiFi connection first,





then run the PilotFUN app

Starting...



The manipulation of the interface



Interface for parsing

The interface for parsing includes the following elements:

- 1** Setting (gear icon)
- 2** Take Picture (camera icon)
- 3** Record Video (video camera icon)
- 4** LED Switch (LED light icon)
- 5** Fine Turning (wrench and screwdriver icon)
- 6** G-sensor control (umbrella icon)
- 7** 360° Tumble (atom icon)
- Power Indicator (battery icon)
- Rotate / Transverse switch (R/T button)
- Forward (up arrow icon)
- Backward (down arrow icon)
- Left_transverse (left arrow icon)
- Right_transverse (right arrow icon)
- Throttle (red button icon) with 0% indicator

1. Allow player to rename their FUNHover, only English alphabet, number, and “_”, “-” is valid for naming
2. Allow player to change the WiFi channel for the chance of better signal TX/RX, channel options: 3, 5, 7, 9
3. Video record time: 5mins, 10mins, no limited (figure)

4. speed mode
5. High
6. Close

1. Press the "Setting" into the interface of system setup.
2. Press the "Take Picture" button to take the picture from the streamed video.
3. Press the "Record Video" button to record the video from the streamed video.
4. Press the "LED switch" button to turn ON/OFF the LED
5. Press the "Fine Turning" button to enter the fine turning mode to fine turn the balance of the helicopter
! Important: the value = 0 means the factory default setting
6. Press the "G-sensor control" button to enter the G-sensor control mode, the button controlled user interface will be disappeared.
7. Press the "360° Tumble" button to enter the tumble mode, and then press one of the 4 direction button to tumble the helicopter in that direction.

Setting

System Setting

Device Name ①

Wi-Fi Channel ② >>

Video Record Time ③ >>

Speed Mode ④ Standard ⑤ High

⑥

Copyright Glovast Technology Ltd. All rights reserved.
Version. 1.0

1. Allow player to rename their FUNHover, only English alphabet, number, and “_”, “-” is valid for naming.
2. Allow player to change the WiFi channel for the chance of better signal TX/RX, channel options: 3, 5, 7, 9
3. Video record time: 5mins, 10mins, no limited (figure)
4. speed mode
5. High
2. 6. Close



Rotate / Transverse

Rotate / Transverse switch
Press the R|T switch will swap the Left and Right button between Rotate and Transverse mode

Slide the throttle button up / down to increase / decrease the motor power
0%

Left_rotate

Right_rotate

Enjoy the happiness of flying and photography !









Quadcopter Battery: 3.7V 500mAh Li battery with protection module(included)
Battery for controller: 4*1.5V AA battery(not included)
Remote control distance: above 30meters
Charging time: 120 minutes
Flying time: 6-9 minutes
Suitable ages: Above 14

Package

1 x 2.4G transmitter
1 x quadcopter
1 x charger
4 x blade
1 x battery
1 x screwdriver
1 x instruction manual

CHINA TOPWIN INDUSTRY CO.,LTD

ADD:B-C of 3/F,Block B,CENTRAL Building,Xixiang Road,BaoAn District,Shenzhen,China

Tel:86-755-83660365 83660404 E-mail:sales@chinatopwin.com

Fax:86-755-83660251 Website:www.chinatopwin.com